

## Guidelines for machine return

These guidelines should show the executive person/department, how the goods should be securely and optimally packed and marked for the return shipment.

We always recommend shipping the return deliveries with the original Komax machine packaging. It offers the optimal protection, is good to handle when moved and transported and it protects from loss. Original Komax packaging can be ordered at Komax AG.



The executive person/department is liable for damages, which are caused by e.g. inadequate packaging, insufficient protection from corrosion or disregard of the marking obligation.

There are valid import rules for the choice of the packaging material, which are defined in the international standards for phyto sanitary measures No. 15 (**ISPM 15**).

## Transportation safety device

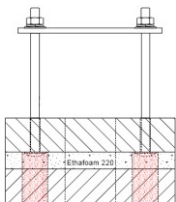

- The machine has to be fixed and stabilized on the vibration damper with nuts, spring rings and washers in order to absorb the vibrations optimally.

## Protection from corrosion & conservation



- VCI foam mats (or comparable alternatives) make sure there is an atmospheric protection for the time of the transport to the point of unpacking.
- Use polyethylene foil as barrier film for the conservation and leaking of the VCI gases.

## Handling symbols (ISO R/780 and DIN 55 402)

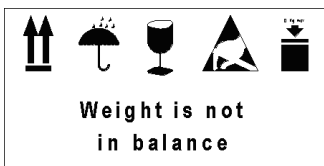

- Centre of gravity:**

If the load point is displaced extremely (e.g. top-heaviness), the balance point has to be marked.

## Marking & labelling of a packaging unit (package)

From: \_\_\_\_\_  
to: \_\_\_\_\_  
no.: \_\_\_\_\_  
L\*B\*H: \_\_\_\_\_  
Brutto weight: \_\_\_\_\_  
Colie no.: \_\_\_\_\_ of: \_\_\_\_\_

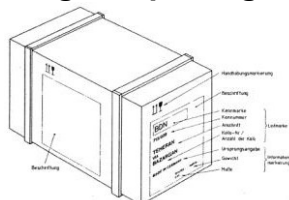

- Customs documents placed **OUTSIDE** the packaging
- Return the parts to the pictured delivery address and send an email with the customs document (**tracking number**) to your responsible contact partner

Komax AG  
Industriestrasse 6  
6036 Dierikon  
Switzerland

**RMA No.**  
Customs documents